

# DI16

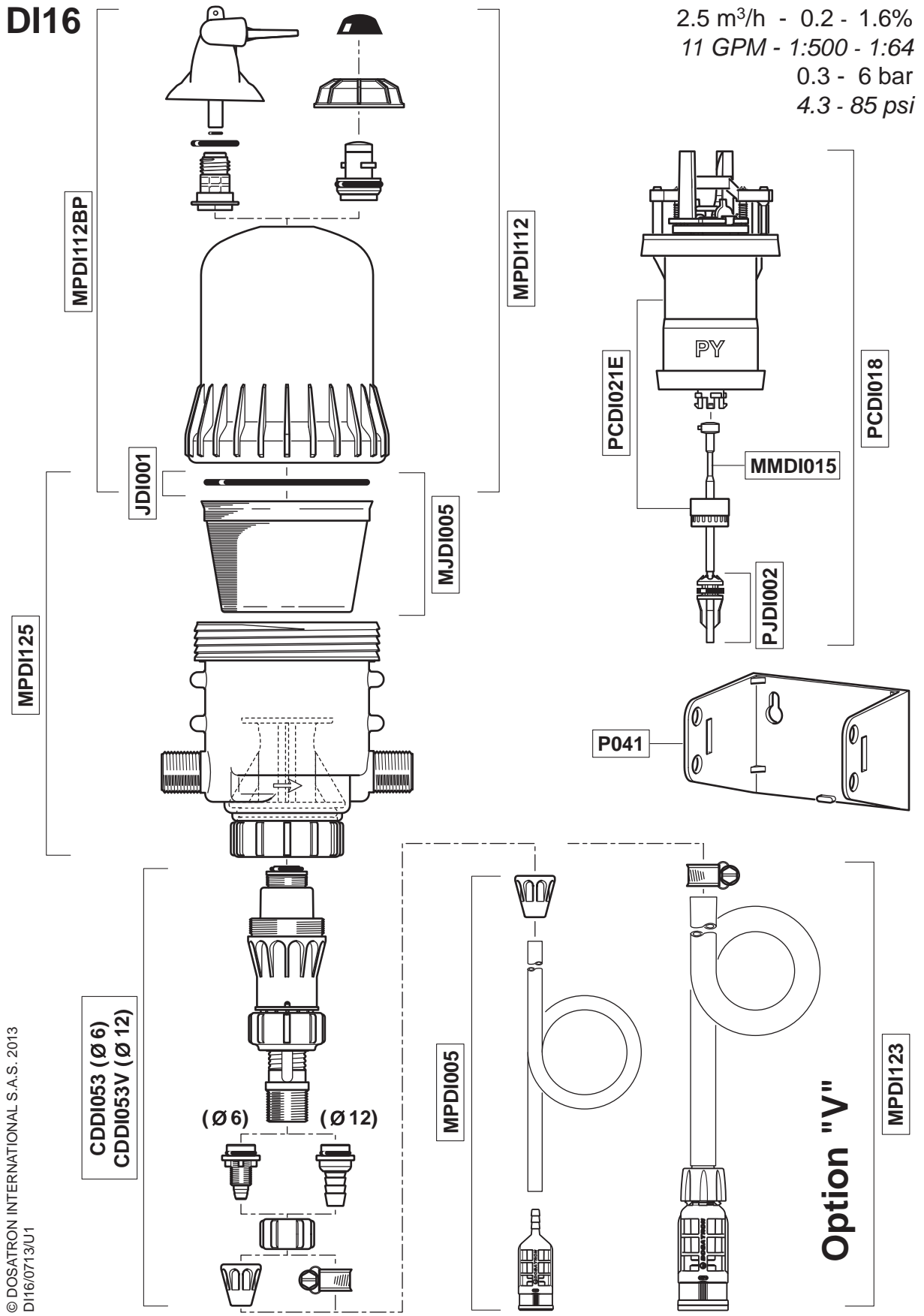

# DI16

2.5 m<sup>3</sup>/h - 0.2 - 1.6%  
11 GPM - 1:500 - 1:64  
0.3 - 6 bar  
4.3 - 85 psi

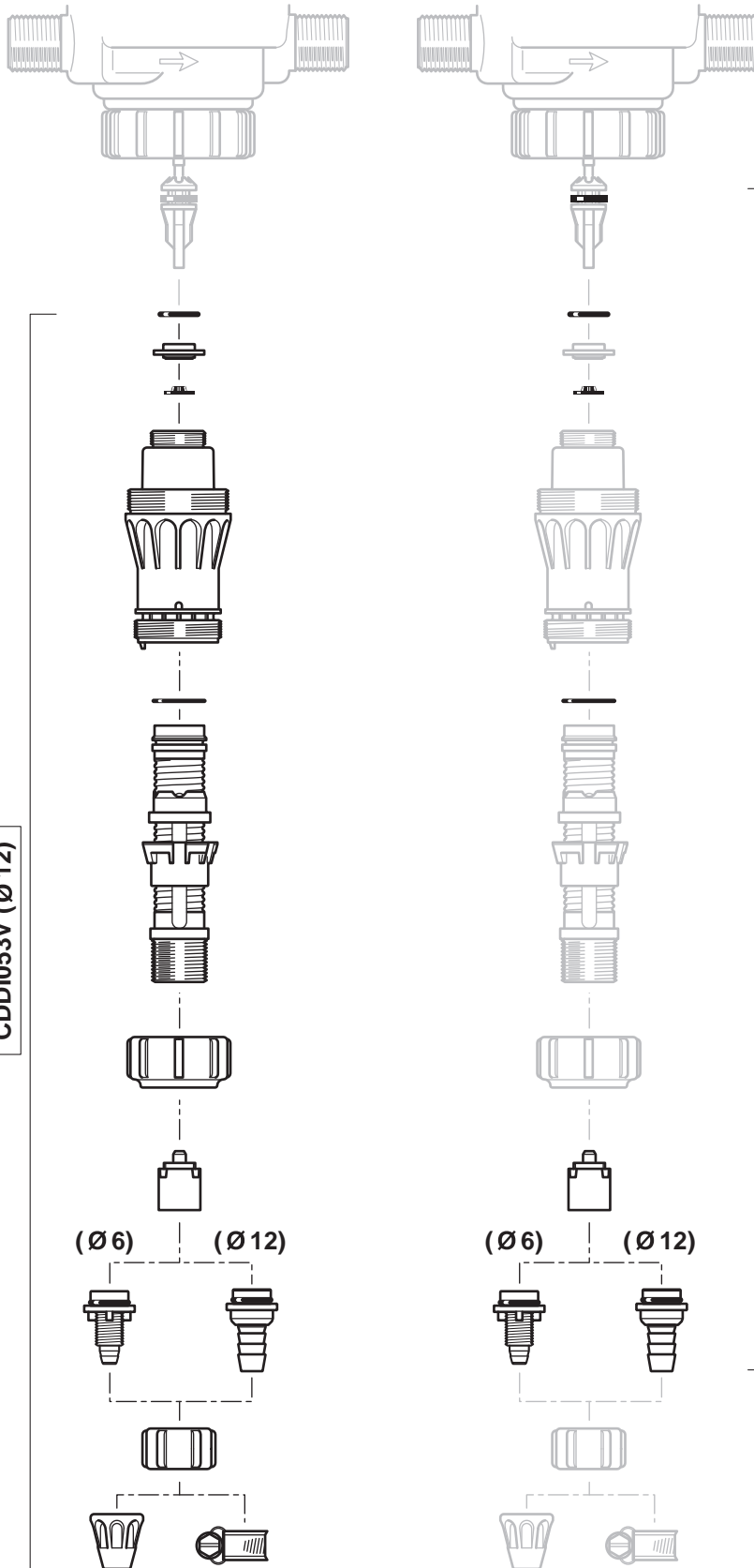

CDDI053 (Ø 6)  
CDDI053V (Ø 12)

PJD1075 (Ø 6)  
PJD1075V (Ø 12)